



DESCRIPTION
CLUTCH JACK

CAPACITY
300 LBS.

MODEL NO.
72030A

REPLACEMENT
PARTS

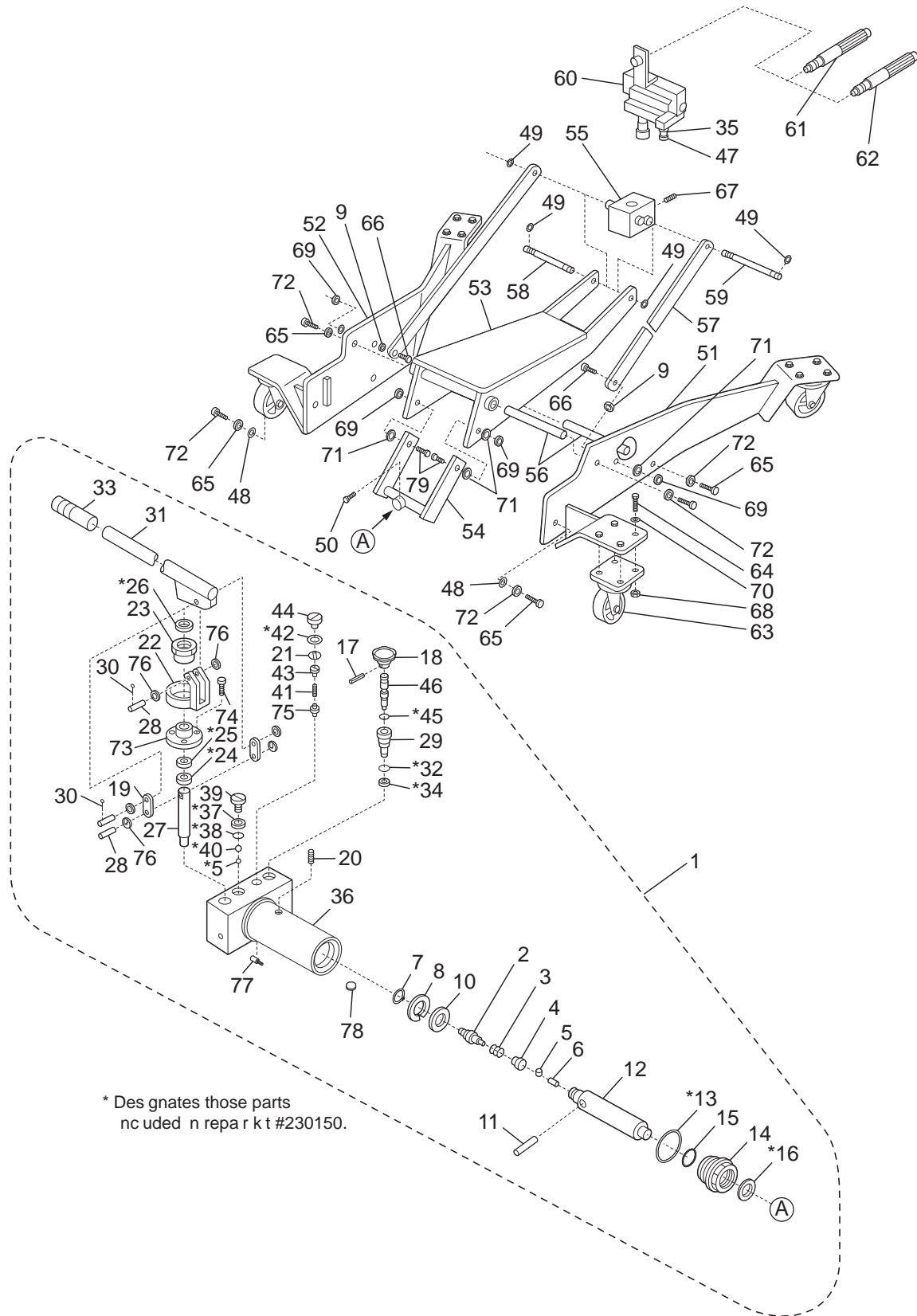

* Des gnat es those parts
nc uded n rep ar k t #230150.

INDEX NO.	DESCRIPTION	PART NO.	REQ'D NO.
1	Hydraulic Block assembly (Complete)	230085	1
2	Filter	230082	1
3	Spring	230083	1
4	Spring Retainer	230084	1
*5	1/4" Diameter Checkball	9004	2
6	Bypass Valve Pin	230086	1
7	Retaining Ring	230087	1
8	U-Cup Seal, Ram	230088	1
9	Teflon Flat Washer	230089	2
10	Ram Bearing	230091	1
11	Bypass Limit Pin	230092	1
12	Ram	230093	1
*13	O-ring	230094	1
14	Cylinder Nut	230096	1
*15	O-ring	230097	1
*16	Oil Seal	230098	1
17	Expansion Pin	230099	1
18	Release Knob	230101	1
19	Pump Link	230102	2
20	Reservoir Fill Plug	230103	1
21	Packing	230104	1
22	Pump Yoke	230106	1
23	Plunger Guide	230107	1
*24	Seal	230108	1
*25	Backup Ring	230109	1
*26	Oil Seal	230111	1
27	Pump Plunger	230112	1
28	Linkage Pin	230113	3
29	Release Valve Guide	230114	1
30	Cotter Pin	230116	6
31	Handle	230117	1
*32	O-ring	230118	1
33	Handle Grip	230119	1
*34	Copper Packing	230121	1
35	Nut	230122	1
36	Hydraulic Block	230123	1
*37	Backup Ring	230124	1
*38	O-ring	230126	1
39	Cover Screw	230127	1
	Repair Kit	230150	1

INDEX NO.	DESCRIPTION	PART NO.	REQ'D NO.
*40	Checkball, 3/8" Diameter	9008	1
41	Overload Spring	230128	1
*42	Packing	230129	1
43	Overload Adjustment Screw	230131	1
44	Cover Screw, Overload	230132	1
*45	O-ring	230133	1
46	Release Valve	230134	1
47	Saddle Adjustment Bolt	230136	1
48	Washer	230137	2
49	Retaining Ring	230138	4
50	Cotter Pin, Trunion	230139	1
51	Right Frame Assembly	230090	1
52	Left Frame Assembly	230095	1
53	Elevator Arm	230141	1
54	Trunion Arm Assembly	230100	1
55	Saddle Base	230142	1
56	Frame Support Bar	230143	2
57	Guide Arm	230144	2
58	Saddle Base Pin	230146	1
59	Guide Arm Pin	230147	1
60	Saddle Assembly	230105	1
61	2" Diameter Spline Shaft	230009	1
62	Optional 1 3/4" Diameter Spline Shaft	72031	1
63	Caster Assembly	230110	4
64	Caster Mounting Bolt	230148	16
65	Bolt	230149	4
66	Guide Arm Bolt	230151	2
67	Saddle Base Set Screw	230152	1
68	Caster Mounting Nut	230153	16
69	Nyloc Nut	230154	2
70	Caster Mounting Washer	230156	16
71	Flat Washer	230157	6
72	Lock Washer	230158	6
73	Plunger Flange	230159	1
74	Flange Screw	230161	4
75	Overload Valve	230162	1
76	Washer	230163	6
77	Filter	230164	1
78	Magnet	230166	1
79	Trunion Arm Bolt	230167	2